

FEATURE

- Accuracy: T/C: 0.3% Pt100Ω: 0.15%
- Wide selection of input with difference sensor type & range
- Dimension small
- Low output ripple
- High stability & low cost



SPECIFICATION

Input Range	Input Impedance	Output Range	Load Resistance
Pt100Ω -100 ~ 800°C (Programming by DS)	≥ 10M ohm	4 ~ 20 mA (2 wired)	≤ (Vs-16) / 20mA (ohm)
Type K 0 ~ 1200°C	≥ 1M ohm		
Type J 0 ~ 1000°C	≥ 1M ohm		
Type E 0 ~ 800°C	≥ 1M ohm		
Type T -50 ~ 400°C	≥ 1M ohm		

- Accuracy: T/C (K, J, E, T): ± 0.3% of F.S.
RTD (Pt100): ± 0.15% of F.S.
- Response time: ≤ 300 msec.
- Span adjustment: ≤ 20% of F.S.
- Zero adjustment: ≤ 10% of F.S.
- Output ripple: ≤ 0.3% of F.S.
- Power**
- Power Supply: DC 20 ~ 36V
- Open circuit protection: Upscale > 22mA
- Environmental**
- Operating temperature: 0~60°C
- Operating relative humidity: 20~95%RH
- Temperature coefficient: ≤ 100 PPM/°C
- Cold junction compensation: 25 ± 10°C, error ≤ 0.5°C
- Storage temperature: -10~70 °C
- Mechanical**
- Dimensions: 42(D)mm x 31(H)mm
- Housing: ABS fire-extinguishing
- Terminals: Screw terminal, ≤ 2.5mm² wire / AWG 14
- Mounting: DIN B-head or larger
- Weight: 50g

ADJUSTMENT

THERMOCOUPLE INPUT:

PT100Ω INPUT:

ZERO: Zero Adjust Pot (Clockwise: o/p increase)

SPAN: Span Adjust Pot (Clockwise: o/p increase)

SW101	1	2	3	4
OFFSET				
+50 °C				ON
+20 °C				ON
0 °C			ON	ON
-20 °C			ON	ON
SW102	1	2	3	4
SPAN	(8)	(4)	(2)	(1)
50 °C				
100 °C				ON
150 °C			ON	ON
200 °C			ON	ON
250 °C		ON	ON	ON
300 °C	ON	ON	ON	ON
350 °C	ON	ON	ON	ON
400 °C	ON	ON	ON	ON
450 °C	ON	ON	ON	ON
500 °C	ON	ON	ON	ON
550 °C	ON	ON	ON	ON
600 °C	ON	ON	ON	ON
650 °C	ON	ON	ON	ON
700 °C	ON	ON	ON	ON
750 °C	ON	ON	ON	ON
800 °C	ON	ON	ON	ON

DIMENSIONS

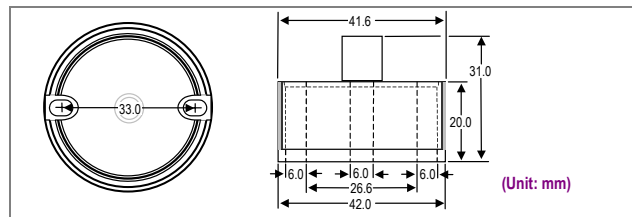

CONNECTION DIAGRAM

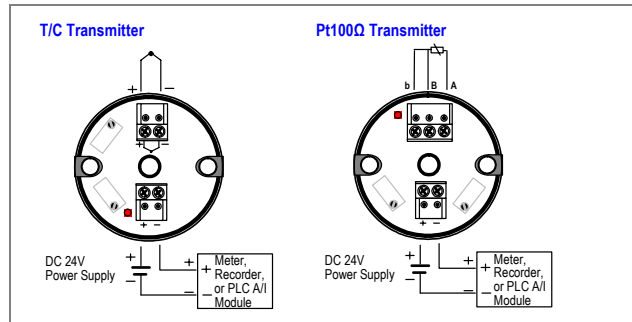

ORDERING INFORMATION

TT — Input Type — Input Range

RTD		THERMOCOUPLE					CODE	TEMPERATURE RANGE
P	K	J	E	T				
●					●	A	-50 ~ +100 °C	
●						B	-10 ~ +40 °C	
●	●	●	●	●	●	C	0 ~ 50 °C	
●	●	●	●	●	●	D	0 ~ 100 °C	
●	●	●	●	●	●	E	0 ~ 200 °C	
●	●	●	●	●	●	F	0 ~ 400 °C	
●	●	●	●	●	●	G	0 ~ 500 °C	
●	●	●	●	●		H	0 ~ 600 °C	
●	●	●	●	●		I	0 ~ 800 °C	
	●	●				J	0 ~ 1000 °C	
	●					K	0 ~ 1200 °C	
	●					L	0 ~ 1300 °C	
						M	400 ~ 1600 °C	
						O	Specify	